

ProScan™ III Automation Controller

Universal Microscope Automation Controller.



Vertical Option



Horizontal Option

Controller Dimensions (mm)

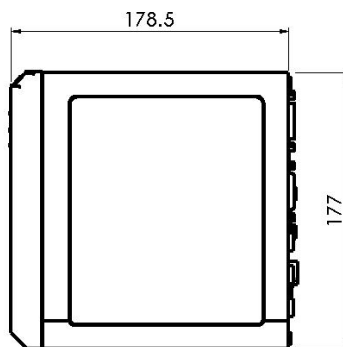
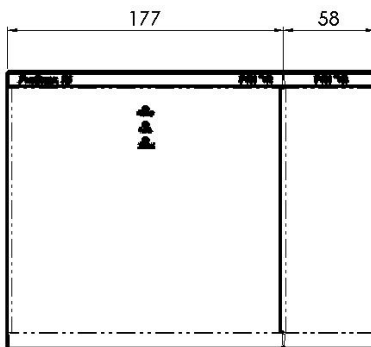

Prior Interactive Control Centre.

PS3J100 local control centre provides positional feedback and the ability to measure distances. The stage can be controlled either via the Joystick or via fine individual X and Y control knobs.



ProScan™ III is the next generation automation controller for motorised microscope accessories. Designed to drive up to 15 axis, the basic module controls 3 axis with the modular design allowing easy expansion for larger automation projects, while providing for a small footprint for simple systems.

The aesthetically pleasing cubic design of the housing provides the opportunity to expand in either the horizontal or vertical directions to suit your needs.

ProScan™ III Features:

- Up to 15 stepper motor axis control
- Intelligent Scanning Technology, IST
- Drives up to 300mm^s⁻¹
- Ultra smooth low speed axis drive
- True USB interface (Vista 64 Compatible)
- Software configurable.
- Automatic setup for accessories.
- Supports the Interactive Control Centre.
- RS232 communications, 115K baud.
- All axis can move simultaneously.
- Accepts Rotary and Linear Encoders.
- Accepts Optical/mechanical Limit switches.
- Controlled in most imaging software.
- Programmable TTL.
- Backwards compatible.

Prior automation products have a reputation for quality and performance. As an ISO 9001:2000 accredited company Prior equipment is designed and manufactured to the highest quality standards. Prior provides full support and service both directly and indirectly through a professional, knowledgeable and extensive global dealer network.

GB Patent No. 2411249

US Patent No. 7330307

Specifications

Number of Axis	15 (3, 6, 9, 12, or 15). Basic unit 3 axis.
Speed Range	0-70 RPS, 6000000 pulses sec ⁻¹ , Ultra Smooth low speed motion. Software configurable.
Acceleration Range	1144mmsec ⁻¹ sec ⁻¹ , 28600000pulses sec ⁻² , software configurable.
Acceleration Curve	Software configurable.
Max Current	1.5 Amps
Holding current	0-1.5 Amps
Current setting	Programmable current setting for both maximum and holding current from 0-1.5Amps.
Command set	Prior Standard
USB communications	USB 2.0, USB Socket type: Connector Gender B, Window XP, Vista32 and Vista 64 compatible.
RS223 communications	2 RS232 connectors with up to 115K baud rates.
TTL communications	4 input and output programmable TTL connections.
Power requirements	150W Max, 110-240V Universal 50-60Hz.
Voltage	38 Volts

Features

AutoSetup:

After attaching accessories the ProScan™ III controller configures the internal settings of the controller to maximise the performance of the accessory.

Programmable TTL:

Program the TTL inputs and outputs to respond to and activate TTL pulses. E.g. open a shutter, move a stage or trigger a filter wheel all with a TTL pulse.

Limit Switches:

The ProScan™ III now supports mechanical and optical limit switches, ideal for none standard applications.

Status Information:

Uniquely for microscope automation controllers ProScan™ III offers controller diagnostics via software, the internal status of the controller is indicated via LED on the unit and can be determined via software.

TTL axis moving trigger function:

Program a dedicated TTL output to pulse after axis has moved a particular distance, ideal for speed slide scanning, trigger a digital camera without stopping the stage to take and image.

Configurable:

The ProScan™ III system is configurable for OEM/B2B solutions and can be modified to suit your application.

Controller Options

ProScan™ III Ordering Information Description

Horizontal	Vertical	Description
H31XYZ	V31XYZ	Stage and focus controller, Coms: RS232, USB, TTL.
H31XYZE	V31XYZE	Encoded stage and Encoded focus controller, Coms: RS232, USB, TTL.
H31F	V31F	3 Filter Wheels and 3 shutter controller, Coms: RS232, USB, TTL.
H31XYZF	V31XYZF	Stage, Focus, 3 Filter Wheels and 3 shutter controller, Coms: RS232, USB, TTL.
H31XYZEF	V31XYZEF	Encoded Stage, Encoded Focus, 3 Filter Wheels and 3 shutter controller, Coms: RS232, USB, TTL.
H31XYZEFE	V31XYZEFE	Encoded Stage, Encoded Focus, 3 Encoded Filter Wheels and 3 shutter controller, Coms: RS232, USB, TTL.



Prior Scientific Limited
Cambridge, UK.
T. +44 (0) 1223 881711
E. uksales@prior.com

Prior Scientific GmbH
Jena, Germany.
T +49 (0)3641 675 650
E. jena@prior.com

Prior Scientific Inc.
Rockland, MA, USA.
T. +1 781-878-8442
E. info@prior.com