

ProScan Hardness Testing Stages

Solid Stages With a Selection of Travel Ranges to Suit Hardness Testing or Micro-positioning of Heavy Loads.



The HT family of Solid Top Stages for Hardness Testing microscopes set new standards for convenience and performance. Designed to operate with point load forces of up to 100Kg these stages are ideal for hardness testing or applications that require micro-positioning of heavy loads.

The ProScan HT stages are available with the following movement ranges;

50 x 50mm (HT5050)

100 x 100mm (HT1010)

110 x 110mm (HT1111)

150 x 150mm (HT1515)

150 x 66mm (HT1566)

250 x 150mm (HT2515)

HT Stage Features:

- Selection of Travel Ranges
- Solid design
- < 1um Resolution
- +/- 1um Repeatability
- Designed for 100Kg Point Loads
- High Precision Ball Screw
- Anti-Backlash Mechanism
- Adjustable Limit Switches

Prior motorised stages have a reputation for quality and performance. As an ISO 9001:2000 accredited company Prior equipment is designed and manufactured to the highest quality standards. Prior provides full support and service both direct and indirect — through a professional, knowledgeable and extensive global dealer network.

HT Stage Dimensions (HT1010)

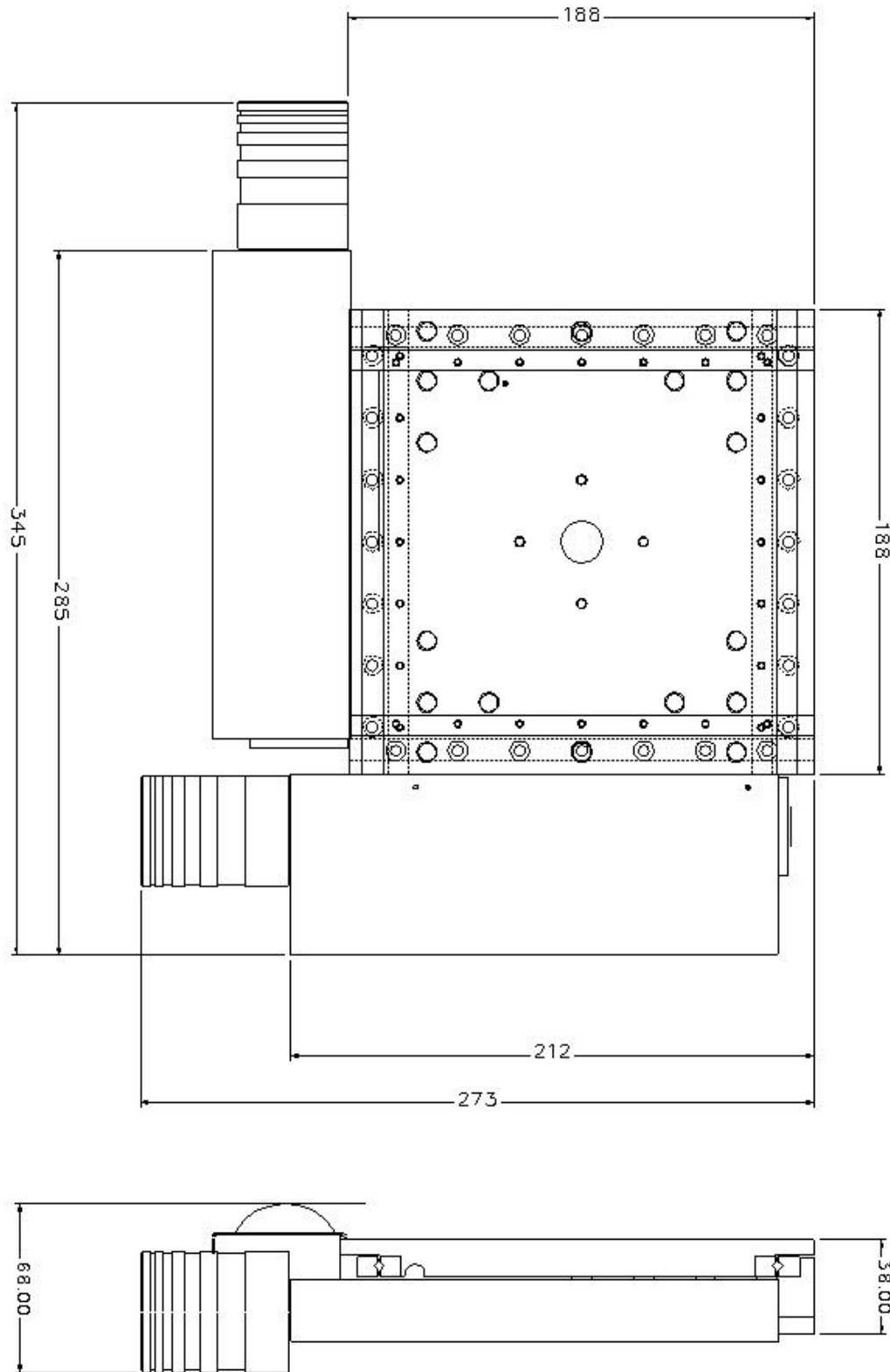

CERTIFICATE NO: FM 61600
STANDARD: BS EN ISO 9001:2000

Prior Scientific Instruments Limited

3-4 Fielding Industrial Estate, Wilbraham Rd, Fulbourn
Cambridge, CB1 5ET. Telephone 01223 881711 Fax 01223 881710

Prior Scientific Inc.

80 Reservoir Park Drive
Rockland, MA 02370-1062. Telephone 781-878-8442 Fax 781-878-8736

VISIT PRIOR ON THE WEB AT **WWW.PRIOR.COM**